

Standard Product List

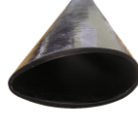

Filament wound tube

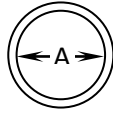

Elliptical filament wound tube

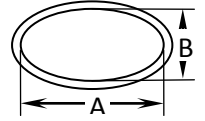

Internal diameter A, mm (in)	Wall thickness, mm (in)	Maximum length available, mm (in)
*10 (0.39)	0.5 to 20 (0.02 to 0.79)	3300 (129.92)
*12 (0.47)	0.5 to 20 (0.02 to 0.79)	4100 (161.42)
*14 (0.55)	0.5 to 20 (0.02 to 0.79)	2800 (110.24)
15 (0.59)	0.5 to 20 (0.02 to 0.79)	2800 (110.24)
*16 (0.63)	0.5 to 20 (0.02 to 0.79)	5000 (196.85)
*19.1 (0.75)	0.5 to 20 (0.02 to 0.79)	4050 (159.45)
*20 (0.79)	0.5 to 20 (0.02 to 0.79)	5000 (196.85)
*22.2 (0.87)	0.5 to 20 (0.02 to 0.79)	4050 (159.45)
23 (0.91)	0.5 to 20 (0.02 to 0.79)	1998 (78.66)
25.4 (1)*	0.5 to 20 (0.02 to 0.79)	3791 (149.25)
26 (1.02)	0.5 to 20 (0.02 to 0.79)	3815 (150.2)
*28 (1.1)	0.5 to 20 (0.02 to 0.79)	2800 (110.24)
30 (1.18)	0.5 to 20 (0.02 to 0.79)	4100 (161.42)
*32 (1.26)	1 to 20 (0.04 to 0.79)	4000 (157.48)
*35 (1.38)	1 to 20 (0.04 to 0.79)	4100 (161.42)
35.2 (1.39)	1 to 20 (0.04 to 0.79)	4059 (159.8)
*38.1 (1.5)	1 to 20 (0.04 to 0.79)	4100 (161.42)
*40 (1.57)	1 to 20 (0.04 to 0.79)	4100 (161.42)
40.4 (1.59)	1 to 20 (0.04 to 0.79)	3042 (119.76)
*44.4 (1.75)	1 to 20 (0.04 to 0.79)	4500 (177.17)
44.7 (1.76)	1 to 20 (0.04 to 0.79)	4922 (193.78)
45.8 (1.8)	1 to 20 (0.04 to 0.79)	3700 (145.67)
47.2 (1.86)	1 to 20 (0.04 to 0.79)	3490 (137.4)
48 (1.89)	1 to 20 (0.04 to 0.79)	2000 (78.74)
*50 (1.97)	1 to 20 (0.04 to 0.79)	5200 (204.72)
50.2 (1.98)	1 to 20 (0.04 to 0.79)	3300 (129.92)
54 (2.13)	1 to 20 (0.04 to 0.79)	4001 (157.52)
57.1 (2.25)	1 to 20 (0.04 to 0.79)	5604 (220.63)
57.5 (2.26)	1 to 20 (0.04 to 0.79)	402 (15.83)
60 (2.36)	1 to 20 (0.04 to 0.79)	5500 (216.54)
60.3 (2.37)	1 to 20 (0.04 to 0.79)	2248 (88.5)
63.6 (2.5)	1 to 20 (0.04 to 0.79)	4805 (189.17)
66.2 (2.61)	1 to 20 (0.04 to 0.79)	4790 (188.58)
66.6 (2.62)	1 to 20 (0.04 to 0.79)	5200 (204.72)
70.1 (2.76)	1 to 20 (0.04 to 0.79)	3500 (137.8)
70.4 (2.77)	1 to 20 (0.04 to 0.79)	5796 (228.19)
72.2 (2.84)	1 to 20 (0.04 to 0.79)	2939 (115.71)
76.3 (3)	1 to 20 (0.04 to 0.79)	5700 (224.41)
78 (3.07)	1 to 20 (0.04 to 0.79)	900 (35.43)
80 (3.15)	1 to 20 (0.04 to 0.79)	5700 (224.41)
80.4 (3.17)	1 to 20 (0.04 to 0.79)	6095 (239.96)
83.6 (3.29)	1 to 20 (0.04 to 0.79)	1293 (50.91)
86.3 (3.4)	1 to 20 (0.04 to 0.79)	6099 (240.12)
90 (3.54)	1 to 20 (0.04 to 0.79)	6103 (240.28)
94.1 (3.7)	1 to 20 (0.04 to 0.79)	2600 (102.36)
99 (3.9)	1 to 20 (0.04 to 0.79)	1050 (41.34)
100 (3.94)	1 to 20 (0.04 to 0.79)	7300 (287.4)
101.5 (4)	1 to 20 (0.04 to 0.79)	4300 (169.29)
102 (4.02)	1 to 20 (0.04 to 0.79)	2200 (86.61)
108.8 (4.28)	1.5 to 20 (0.06 to 0.79)	3440 (135.43)
114.4 (4.5)	1.5 to 20 (0.06 to 0.79)	4950 (194.88)
118 (4.64)	1.5 to 20 (0.06 to 0.79)	1750 (68.9)
120.1 (4.73)	1.5 to 20 (0.06 to 0.79)	2752 (108.35)
125 (4.92)	1.5 to 20 (0.06 to 0.79)	4250 (167.32)
127 (5)	1.5 to 20 (0.06 to 0.79)	5650 (222.44)
137 (5.39)	1.5 to 20 (0.06 to 0.79)	5260 (207.09)
144 (5.67)	1.5 to 20 (0.06 to 0.79)	2253 (88.7)
152 (5.98)	1.5 to 20 (0.06 to 0.79)	8050 (316.93)
152.7 (6.01)	1.5 to 20 (0.06 to 0.79)	3240 (127.56)
165 (6.5)	1.5 to 20 (0.06 to 0.79)	6755 (265.94)
178 (7.01)	1.5 to 20 (0.06 to 0.79)	2150 (84.65)
203 (7.99)	1.5 to 20 (0.06 to 0.79)	8050 (316.93)
206 (8.11)	1.5 to 20 (0.06 to 0.79)	11250 (442.91)
216.9 (8.54)	1.5 to 20 (0.06 to 0.79)	2100 (82.68)
220 (8.66)	1.5 to 20 (0.06 to 0.79)	10405 (409.65)
250 (9.84)	1.5 to 20 (0.06 to 0.79)	9055 (356.5)
253.9 (10)	1.5 to 20 (0.06 to 0.79)	950 (37.4)
337.8 (13.3)	1.5 to 20 (0.06 to 0.79)	1903 (74.92)
353 (13.9)	1.5 to 20 (0.06 to 0.79)	1100 (43.31)
421.3 (16.59)	1.5 to 20 (0.06 to 0.79)	1150 (45.28)
612 (24.09)	1.5 to 20 (0.06 to 0.79)	2200 (86.61)
762 (30)	1.5 to 20 (0.06 to 0.79)	2200 (86.61)

* denotes available online at CST Express, www.cstexpress.com

Shape	Major A, mm (in)	Minor B, mm (in)	Average wall thickness, mm (in)	Maximum length available, mm (in)
Streamline Foil	30 (1.18)	12.6 (0.5)	1.5 (0.06)	2000 (78.74)
Streamline Foil	34.3 (1.35)	14.4 (0.57)	2 (0.08)	1900 (74.8)
Streamline Foil	43.8 (1.72)	17.8 (0.7)	1.5 (0.06)	2300 (90.55)
Streamline Foil	52.6 (2.07)	21.6 (0.85)	1.7 (0.07)	3100 (122.05)
Streamline Foil	60 (2.36)	25.3 (1)	1.8 (0.07)	2300 (90.55)
Streamline Foil	68.6 (2.7)	28.5 (1.12)	2 (0.08)	2400 (94.49)
Streamline Foil	73 (2.87)	34.2 (1.35)	1.8 (0.07)	1200 (47.24)
Streamline Foil	94 (3.7)	39.5 (1.56)	2.2 (0.09)	2600 (102.36)
Squared Elliptical	75 (2.95)	35 (1.38)	1.5 (0.06)	2450 (96.46)
Squared Elliptical	75 (2.95)	35 (1.38)	2.1 (0.08)	2450 (96.46)
Squared Elliptical	95 (3.74)	45 (1.77)	2 (0.08)	3150 (124.02)
Squared Elliptical	75 (2.95)	35 (1.38)	1.5 (0.06)	2450 (96.46)
D-Elliptical	113 (4.45)	71 (2.8)	2.5 (0.1)	1190 (46.85)
D-Elliptical	120 (4.72)	78 (3.07)	3 (0.12)	1540 (60.63)
D-Elliptical	134 (5.28)	84 (3.31)	3 (0.12)	1710 (67.32)
D-Elliptical	142 (5.59)	92 (3.62)	3.3 (0.13)	2010 (79.13)
D-Elliptical	191 (7.52)	111 (4.37)	4.5 (0.18)	3540 (139.37)

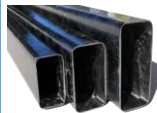

Rectangular / square filament wound tube

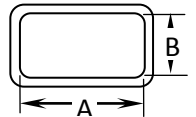

Shape	Major A, mm (in)	Minor B, mm (in)	Wall thickness, mm (in)	Maximum length available, mm (in)
Rectangular (Radius Corners)	80 (3.15)	40 (1.57)	1.5 to 8 (0.06 to 0.31)	3250 (127.95)
Rectangular (Radius Corners)	100 (3.94)	50 (1.97)	1.5 to 8 (0.06 to 0.31)	3850 (151.57)
Rectangular (Radius Corners)	125 (4.92)	50 (1.97)	1.5 to 8 (0.06 to 0.31)	4030 (158.66)
Rectangular (Radius Corners)	150 (5.91)	50 (1.97)	1.5 to 8 (0.06 to 0.31)	4615 (181.69)
Square (Radius Corners)	50 (1.97)	50 (1.97)	1.5 to 8 (0.06 to 0.31)	2250 (88.58)
Square (Radius Corners)	100 (3.94)	100 (3.94)	1.5 to 8 (0.06 to 0.31)	600 (23.62)

Pultruded profiles



Shape	Dimensions, mm (in)	Resin type	Maximum length available, m (ft)
Round Solid	Ø9.1 (Ø0.36)	VE / EP	12 (40)
Round Solid	Ø15 (Ø0.59)	VE / EP	12 (40)
Round Solid	Ø19 (Ø0.75)	EP	12 (40)
Rectangular Bar	10 x 5 (0.39 x 0.2)	VE / EP	12 (40)
Rectangular Bar	15 x 7.5 (0.59 x 0.3)	VE / EP	12 (40)
Rectangular Bar	20 x 10 (0.79 x 0.39)	VE / EP	12 (40)
Rectangular Bar	25 x 12.5 (0.98 x 0.49)	EP	12 (40)
*Flat Strip	51 x 1-6 (1 x 0.04-0.24)	VE / EP	12 (40)
*Flat Strip	76 x 1-6 (3 x 0.04-0.24)	VE / EP	12 (40)
*Flat Strip	101 x 1-6 (4 x 0.04-0.24)	VE / EP	12 (40)

*denotes available with peel ply surface finish

For more information, please contact our sales team:

T: +61 2 9668 8488

E: sales@cstcomposites.com



Global-Mark.com.au®