

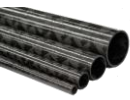

## Standard Product List

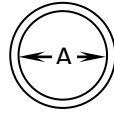

Filament wound tube



Elliptical filament wound tube

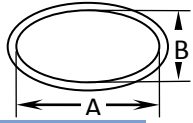

CST EXPRESS	Internal diameter A mm (in)	Wall thickness, mm (in)	Maximum length, mm (in)
In Store	10 (0.39)	0.5 to 20 (0.02 to 0.79)	3300 (129.92)
In Store	12 (0.47)	0.5 to 20 (0.02 to 0.79)	4100 (161.42)
Enquire	13 (0.51)	0.5 to 20 (0.02 to 0.79)	2800 (110.24)
In Store	14 (0.55)	0.5 to 20 (0.02 to 0.79)	2800 (110.24)
Enquire	15 (0.59)	0.5 to 20 (0.02 to 0.79)	2800 (110.24)
In Store	16 (0.63)	0.5 to 20 (0.02 to 0.79)	5000 (196.85)
Enquire	19.1 (0.75)	0.5 to 20 (0.02 to 0.79)	4050 (159.45)
In Store	20 (0.79)	0.5 to 20 (0.02 to 0.79)	5000 (196.85)
In Store	22.2 (0.87)	0.5 to 20 (0.02 to 0.79)	4050 (159.45)
Enquire	23 (0.91)	0.5 to 20 (0.02 to 0.79)	1998 (78.66)
In Store	25.4 (1)	0.5 to 20 (0.02 to 0.79)	3791 (149.25)
Enquire	26 (1.02)	0.5 to 20 (0.02 to 0.79)	3815 (150.2)
In Store	28 (1.1)	0.5 to 20 (0.02 to 0.79)	2800 (110.24)
Enquire	30 (1.18)	0.5 to 20 (0.02 to 0.79)	4100 (161.42)
In Store	32 (1.26)	1 to 20 (0.04 to 0.79)	4000 (157.48)
In Store	35 (1.38)	1 to 20 (0.04 to 0.79)	4100 (161.42)
Enquire	35.2 (1.39)	1 to 20 (0.04 to 0.79)	4059 (159.8)
In Store	38.1 (1.5)	1 to 20 (0.04 to 0.79)	4100 (161.42)
In Store	40 (1.57)	1 to 20 (0.04 to 0.79)	4100 (161.42)
Enquire	40.4 (1.59)	1 to 20 (0.04 to 0.79)	3042 (119.76)
In Store	44.4 (1.75)	1 to 20 (0.04 to 0.79)	4500 (177.17)
Enquire	44.7 (1.76)	1 to 20 (0.04 to 0.79)	4922 (193.78)
Enquire	45.8 (1.8)	1 to 20 (0.04 to 0.79)	3700 (145.67)
Enquire	47.2 (1.86)	1 to 20 (0.04 to 0.79)	3490 (137.4)
Enquire	48 (1.89)	1 to 20 (0.04 to 0.79)	2000 (78.74)
In Store	50 (1.97)	1 to 20 (0.04 to 0.79)	5200 (204.72)
Enquire	50.2 (1.98)	1 to 20 (0.04 to 0.79)	3300 (129.92)
Enquire	54 (2.13)	1 to 20 (0.04 to 0.79)	4001 (157.52)
Enquire	57.1 (2.25)	1 to 20 (0.04 to 0.79)	5604 (220.63)
Enquire	57.5 (2.26)	1 to 20 (0.04 to 0.79)	402 (15.83)
Enquire	60 (2.36)	1 to 20 (0.04 to 0.79)	5500 (216.54)
Enquire	60.3 (2.37)	1 to 20 (0.04 to 0.79)	2248 (88.5)
Enquire	63.6 (2.5)	1 to 20 (0.04 to 0.79)	4805 (189.17)
Enquire	66.2 (2.61)	1 to 20 (0.04 to 0.79)	4790 (188.58)
Enquire	66.6 (2.62)	1 to 20 (0.04 to 0.79)	5200 (204.72)
Enquire	70.1 (2.76)	1 to 20 (0.04 to 0.79)	3500 (137.8)
Enquire	70.4 (2.77)	1 to 20 (0.04 to 0.79)	5796 (228.19)
Enquire	72.2 (2.84)	1 to 20 (0.04 to 0.79)	2939 (115.71)
Enquire	76.3 (3)	1 to 20 (0.04 to 0.79)	5700 (224.41)
Enquire	78 (3.07)	1 to 20 (0.04 to 0.79)	900 (35.43)
Enquire	80 (3.15)	1 to 20 (0.04 to 0.79)	5700 (224.41)
Enquire	80.4 (3.17)	1 to 20 (0.04 to 0.79)	6095 (239.96)
Enquire	83.6 (3.29)	1 to 20 (0.04 to 0.79)	1293 (50.91)
Enquire	86.3 (3.4)	1 to 20 (0.04 to 0.79)	6099 (240.12)
Enquire	90 (3.54)	1 to 20 (0.04 to 0.79)	6103 (240.28)
Enquire	94.1 (3.7)	1 to 20 (0.04 to 0.79)	2600 (102.36)
Enquire	99 (3.9)	1 to 20 (0.04 to 0.79)	1050 (41.34)
Enquire	100 (3.94)	1 to 20 (0.04 to 0.79)	7300 (287.4)
Enquire	101.5 (4)	1 to 20 (0.04 to 0.79)	4300 (169.29)
Enquire	102 (4.02)	1 to 20 (0.04 to 0.79)	2200 (86.61)
Enquire	108.8 (4.28)	1.5 to 20 (0.06 to 0.79)	3440 (135.43)
Enquire	114.4 (4.5)	1.5 to 20 (0.06 to 0.79)	4950 (194.88)
Enquire	118 (4.64)	1.5 to 20 (0.06 to 0.79)	1750 (68.9)
Enquire	120.1 (4.73)	1.5 to 20 (0.06 to 0.79)	2752 (108.35)
Enquire	125 (4.92)	1.5 to 20 (0.06 to 0.79)	4250 (167.32)
Enquire	127 (5)	1.5 to 20 (0.06 to 0.79)	5650 (222.44)
Enquire	137 (5.39)	1.5 to 20 (0.06 to 0.79)	5260 (207.09)
Enquire	144 (5.67)	1.5 to 20 (0.06 to 0.79)	2253 (88.7)
Enquire	152 (5.98)	1.5 to 20 (0.06 to 0.79)	8050 (316.93)
Enquire	152.7 (6.01)	1.5 to 20 (0.06 to 0.79)	3240 (127.56)
Enquire	165 (6.5)	1.5 to 20 (0.06 to 0.79)	6755 (265.94)
Enquire	178 (7.01)	1.5 to 20 (0.06 to 0.79)	2150 (84.65)
Enquire	203 (7.99)	1.5 to 20 (0.06 to 0.79)	8050 (316.93)
Enquire	206 (8.11)	1.5 to 20 (0.06 to 0.79)	11250 (442.91)
Enquire	216.9 (8.54)	1.5 to 20 (0.06 to 0.79)	2100 (82.68)
Enquire	220 (8.66)	1.5 to 20 (0.06 to 0.79)	10405 (409.65)
Enquire	250 (9.84)	1.5 to 20 (0.06 to 0.79)	9055 (356.5)
Enquire	253.9 (10)	1.5 to 20 (0.06 to 0.79)	950 (37.4)
Enquire	337.8 (13.3)	1.5 to 20 (0.06 to 0.79)	1903 (74.92)
Enquire	353 (13.9)	1.5 to 20 (0.06 to 0.79)	1100 (43.31)
Enquire	421.3 (16.59)	1.5 to 20 (0.06 to 0.79)	1150 (45.28)
Enquire	612 (24.09)	1.5 to 20 (0.06 to 0.79)	2200 (86.61)
Enquire	762 (30)	1.5 to 20 (0.06 to 0.79)	2200 (86.61)

Shape	Major A, mm (in)	Minor B, mm (in)	Average wall thickness, mm (in)	Maximum length available, mm (in)
Streamline Foil	30 (1.18)	12.6 (0.5)	1.5 (0.06)	2000 (78.74)
Streamline Foil	34.3 (1.35)	14.4 (0.57)	2 (0.08)	1900 (74.8)
Streamline Foil	43.8 (1.72)	17.8 (0.7)	1.5 (0.06)	2300 (90.55)
Streamline Foil	52.6 (2.07)	21.6 (0.85)	1.7 (0.07)	3100 (122.05)
Streamline Foil	60 (2.36)	25.3 (1)	1.8 (0.07)	2300 (90.55)
Streamline Foil	68.6 (2.7)	28.5 (1.12)	2 (0.08)	2400 (94.49)
Streamline Foil	73 (2.87)	34.2 (1.35)	1.8 (0.07)	1200 (47.24)
Streamline Foil	94 (3.7)	39.5 (1.56)	2.2 (0.09)	2600 (102.36)
Squared Elliptical	75 (2.95)	35 (1.38)	1.5 (0.06)	2450 (96.46)
Squared Elliptical	75 (2.95)	35 (1.38)	2.1 (0.08)	2450 (96.46)
Squared Elliptical	95 (3.74)	45 (1.77)	2 (0.08)	3150 (124.02)
Squared Elliptical	75 (2.95)	35 (1.38)	1.5 (0.06)	2450 (96.46)
D-Elliptical	113 (4.45)	71 (2.8)	2.5 (0.1)	1190 (46.85)
D-Elliptical	120 (4.72)	78 (3.07)	3 (0.12)	1540 (60.63)
D-Elliptical	134 (5.28)	84 (3.31)	3 (0.12)	1710 (67.32)
D-Elliptical	142 (5.59)	92 (3.62)	3.3 (0.13)	2010 (79.13)
D-Elliptical	191 (7.52)	111 (4.37)	4.5 (0.18)	3540 (139.37)

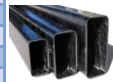

Rectangular / square filament wound tube

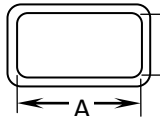

Shape	Major A, mm (in)	Minor B, mm (in)	Wall thickness, mm (in)	Maximum length available, mm (in)
Rectangular (Radius Corners)	80 (3.15)	40 (1.57)	1.5 to 8 (0.06 to 0.31)	3250 (127.95)
Rectangular (Radius Corners)	100 (3.94)	50 (1.97)	1.5 to 8 (0.06 to 0.31)	3850 (151.57)
Rectangular (Radius Corners)	125 (4.92)	50 (1.97)	1.5 to 8 (0.06 to 0.31)	4030 (158.66)
Rectangular (Radius Corners)	150 (5.91)	50 (1.97)	1.5 to 8 (0.06 to 0.31)	4615 (181.69)
Square (Radius Corners)	50 (1.97)	50 (1.97)	1.5 to 8 (0.06 to 0.31)	2250 (88.58)
Square (Radius Corners)	100 (3.94)	100 (3.94)	1.5 to 8 (0.06 to 0.31)	600 (23.62)

## Pultruded profiles



Shape	Dimensions, mm (in)	Resin type	Maximum length available, m (ft)
Round Solid	Ø9.1 (Ø0.36)	VE / EP	12 (40)
Round Solid	Ø15 (Ø0.59)	VE / EP	12 (40)
Round Solid	Ø19 (Ø0.75)	EP	12 (40)
Rectangular Bar	10 x 5 (0.39 x 0.2)	VE / EP	12 (40)
Rectangular Bar	15 x 7.5 (0.59 x 0.3)	VE / EP	12 (40)
Rectangular Bar	20 x 10 (0.79 x 0.39)	VE / EP	12 (40)
Rectangular Bar	25 x 12.5 (0.98 x 0.49)	EP	12 (40)
*Flat Strip	51 x 1-6 (1 x 0.04-0.24)	VE / EP	12 (40)
*Flat Strip	76 x 1-6 (3 x 0.04-0.24)	VE / EP	12 (40)
*Flat Strip	101 x 1-6 (4 x 0.04-0.24)	VE / EP	12 (40)

\*denotes available with peel ply surface finish

For more information, please contact our sales team:

T: +61 2 9668 8488

Email: sales@cstcomposites.com

